

GENERAL NOTES:

1. PROVIDE STEEL LINTELS AT ALL BRICK OPENINGS AS REQUIRED.
2. BRICK VENEER MUST BE SUPPORTED BY NON-COMBUSTIBLE MATERIALS TO FOOTING PER LICENSED ENGINEER.
3. PROVIDE SCREENED SOFFIT VENTS AT 96" O.C. AROUND HOUSE. CONTINUOUS AT ALL VAULTS. AND PROVIDE PROPER ROOF VENTILATION PER LOCAL BUILDING CODE REQUIREMENTS.
4. ALL WINDOW SIZES SHOWN ARE NOMINAL - CONSULT WINDOW MANUFACTURER AND/OR GENERAL CONTRACTOR FOR ACTUAL SIZES, AND ROUGH OPENING SIZES. VERIFY THAT ALL APPLICABLE WINDOWS MEET EGRESS REQUIREMENTS FOR LOCAL BUILDING CODES.
5. CREATIVE HOME DESIGNS, INC. SHALL NOT BE RESPONSIBLE FOR FIELD CHANGES OR CLIENT ALTERATIONS TO THIS PLAN.

NOTE:

CREATIVE HOME DESIGNS, INC. DOES NOT PRACTICE STRUCTURAL ENGINEERING; THEREFORE, ALL BEAMS, CONNECTORS, SOLID BEARING LOCATIONS, AND ALL OTHER STRUCTURAL ITEMS ARE TO BE REVIEWED AND DESIGNED BY A LICENSED STRUCTURAL ENGINEER. THEN ACCORDINGLY, CREATIVE HOME DESIGNS, INC. ASSUMES NO RESPONSIBILITY FOR THE STRUCTURAL INTEGRITY OF THE BUILDING. HOWEVER, ANY DESIGN ELEMENTS THAT MAY NEED TO BE ALTERED DUE TO STRUCTURAL ITEMS MUST BE APPROVED BY THE OWNER AND / OR CREATIVE HOME DESIGNS, INC.

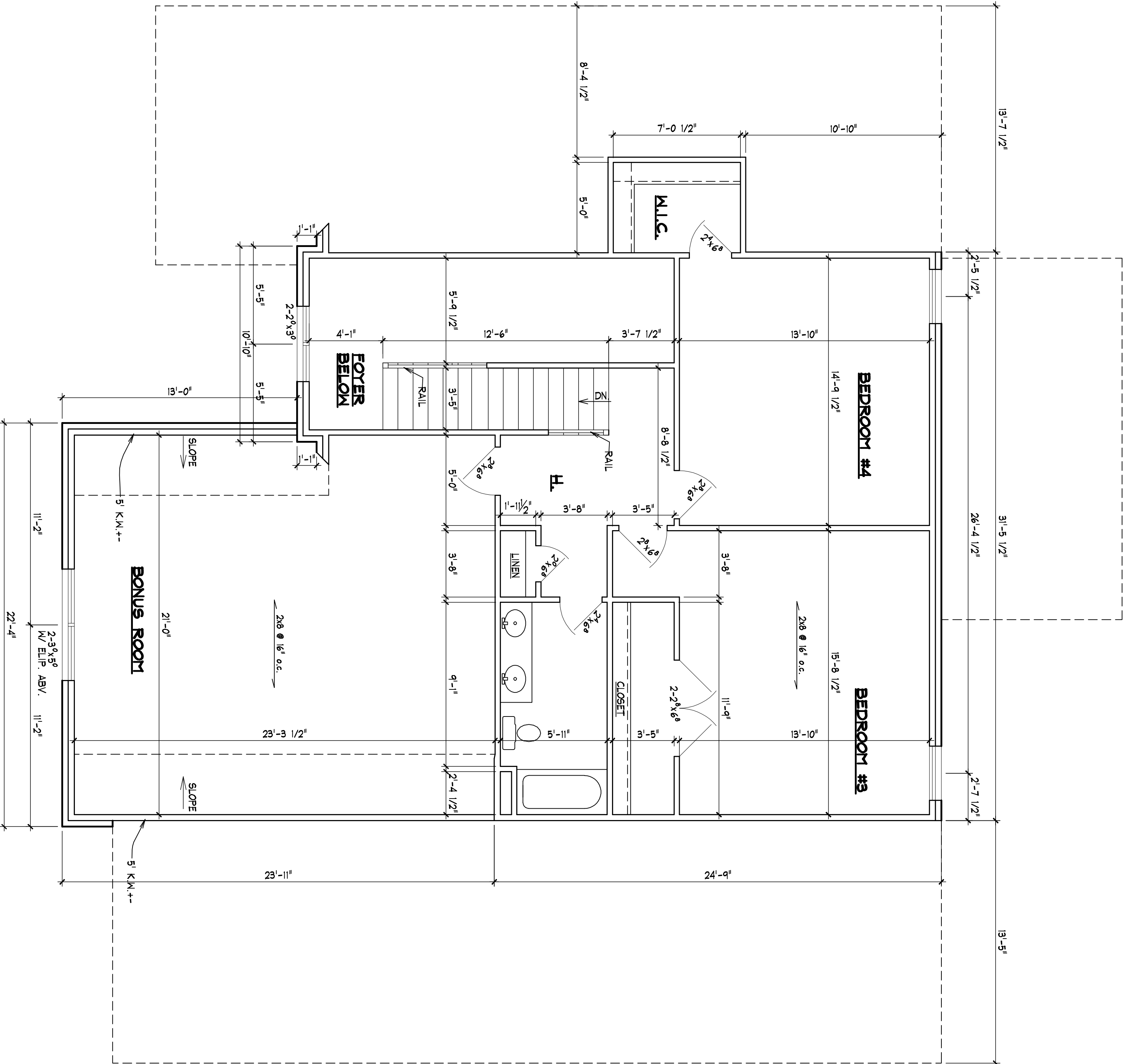

SECOND FLOOR PLAN

SCALE 1/8"=1'-0"

COPYRIGHT © BY CREATIVE HOME DESIGNS, INC. OF MIDDLE TENNESSEE. ALL RIGHTS RESERVED.

DATE: 4-3-14
 DRAWN BY: P.S.
 CHECKED BY: B1
 2068
 SHEET: 4

It is the intent of these documents to provide sufficient information to the experienced builder to construct the project shown; it is therefore his responsibility to verify accuracy and compliance with all regulatory agencies prior to construction; and their requirements must take precedence over those shown.

CREATIVE HOME DESIGNS, INC.
 OF MIDDLE TENNESSEE
 745 S. Church St., Suite 230
 Murfreesboro, TN 37130 (615) 890-2855

While every attempt has been made in the preparation of this plan to avoid errors, omissions, and mistakes, the designer can not guarantee against human error. The contractor and/or client shall verify all conditions, dimensions, details and specifications and be responsible for same. The designer will not be liable for human error after construction begins.
